

Lot Line Footings

Where footings are located adjacent to a lot line, it is necessary to increase the thickness of the footing to result in the same load distribution as a common footing (see illustration). It is important to consider any necessary adjustments as this requirement may impact finished building grade and proper drainage.

Conventional Footing

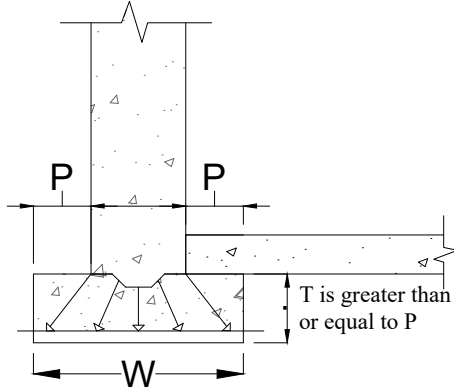

Lot Line Footing

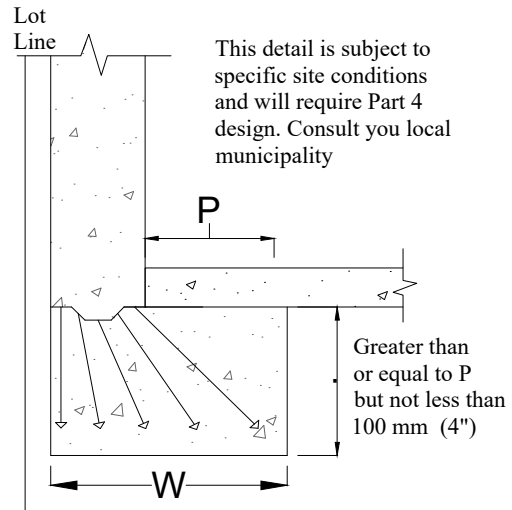

High Water Table

When 'X' is less than 'A', the values for footing sizes in Figures 2.8 & 2.10 must be doubled (9.15.4.3.(3))

Alternatively, a compacted granular layer can be used to raise footings (9.14.4.)

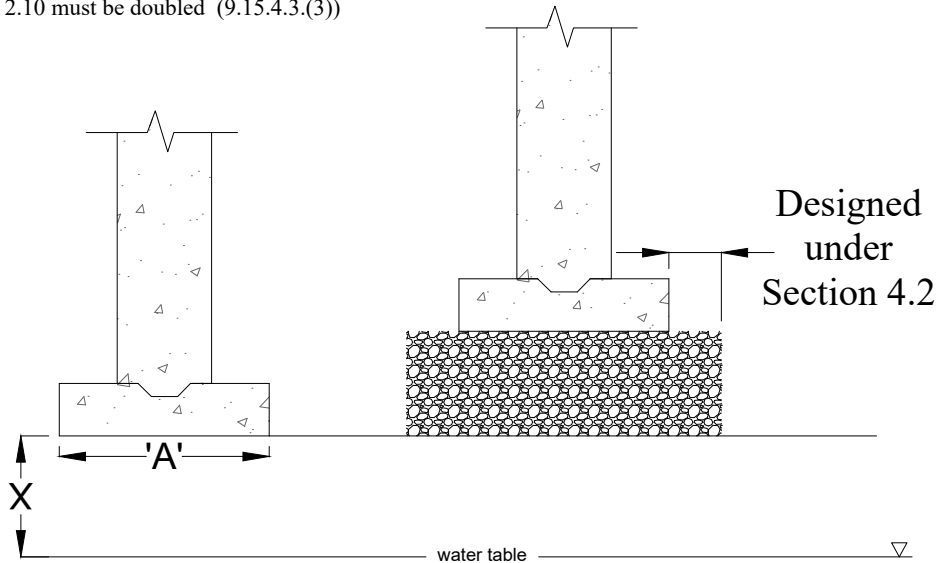

TOWN OF
GRIMSBY

Footing Detail A1

ADDRESS:

160 Livingston Ave.

APPLICANT:

Building Dept.

DATE:

2025/01/10

www.grimsby.ca

Step Footings

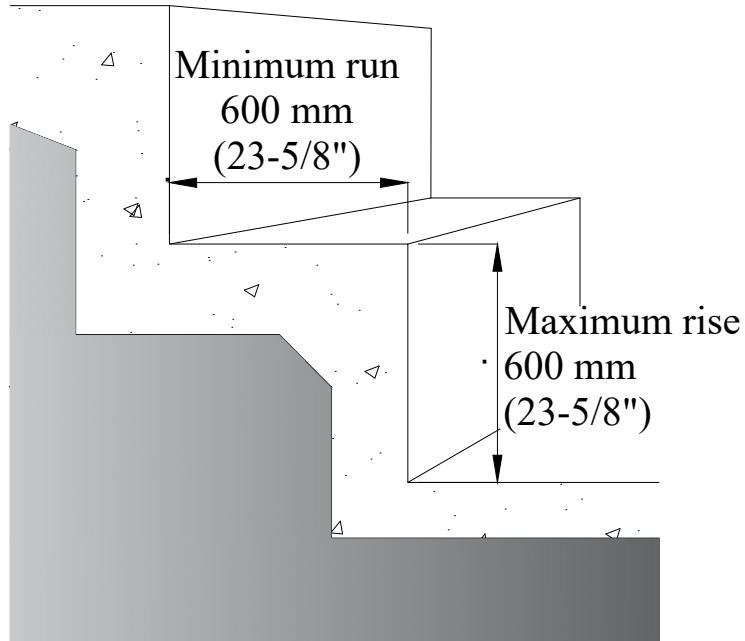

Low-Bearing Capacity Soil

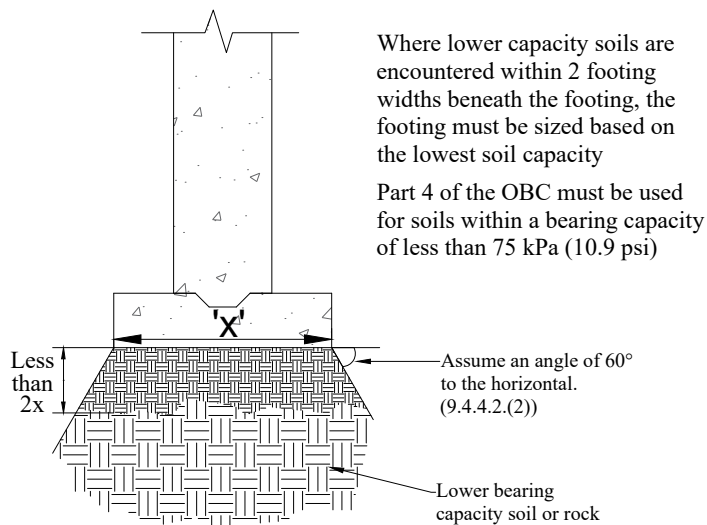

Footing Detail A2



TOWN OF
GRIMSBY

ADDRESS:

160 Livingston Ave.

APPLICANT:

Building Dept.

DATE:

2025/01/10

www.grimsby.ca